



EARTH



FIRE



WATER



AIR

Element

www.GoElementRV.com



TIMBER STONE BROWN



VINTAGE RED



CLEAR WATER BLUE



ARCTIC WHITE



THE ELEMENT OF DESIGN

The Element is a fusion of classic American automotive design and the latest in aerodynamic, European-inspired camping trailers.

- Built to be both environmentally friendly and stylish, the Element is also built tough with the latest in sustainable composites.
- Nearly wood free, the Element is ultra resistant to rot, mold and mildew. CompositTek™ Construction makes the Element eco-friendly and recyclable.
- European-styled windows are crafted of tinted acrylic to provide energy efficiency and privacy.
- The interior appointments are clean, functional and ready for the rigors of today's most active family.



THE ELEMENT OF CHANGE BEGINS FROM THE GROUND UP

The departure from conventional recreational vehicles begins from the ground up with the chassis.

- The most durable, lightweight frame available is engineered from automotive, High Strength Low Alloy (HSLA) steel that yields the highest strength-to-weight ratio.
- The frame incorporates little to no welding that can crack or separate. Instead, Element frame components are secured with an intricate system of bolts and interlocking grooves to increase strength and reduce weight.
- Each frame component is protected with a high quality electro-coating process that coats 100% of the frame to retard rust and corrosion.



PROTECTION FROM THE ELEMENTS

The unitized-body construction of the Element is much like nature's exoskeleton. Lightweight, all-composite, panelized components fit tightly together and are then fused and fastened to form a one-piece outer shell.

- This outer shell is stronger and more aerodynamic than conventionally built trailers.
- Seamless, vacuum bonded components have a heavy gauge welded aluminum core frame for added strength.



INSIDE AND OUTSIDE OF YOUR ELEMENT

You'll be amazed at the living space inside this mid-sized camping trailer. Without the need for interior structural wall supports, a European-styled, open-concept interior becomes a reality.

- Weighing in at an approximate base of 3,300 pounds, the 24-foot Element series can be towed by many of today's mini vans or mid-sized SUVs.
- The clean, modern and fluid lines in the interior of the Element provide an uncluttered elegance designed for camping simplicity. Interior height is a surprising 84 inches.



Frontal Area Compliant

The Element product line is designed to meet the 60 square foot frontal area limitations suggested by many tow vehicle manufacturers. The frontal area of the trailer is the portion of the trailer that interacts in combination with the tow vehicle's wind stream to create resistance. Greater wind resistance caused by a trailer results in reduced fuel economy and greater strain on the tow vehicle, especially at highway speeds.

Advanced Fulcrum Tracking (AFT)

Advanced Fulcrum Tracking (AFT) is a combination of design features incorporated into the Element 24 series product that improves towing stability and tracking. The use of lightweight construction materials allows the center of gravity to be located to the extreme rear portion of the trailer allowing the axle to be further aft than conventional designs without adversely affecting the tongue weight. The aft located axle improves stability by reducing the length of the body which is cantilevered to the rear of the axle and subject to inducing forces on the tow vehicle such as sway or lift. The single axle configuration improves straight-line tracking by eliminating tracking misalignment common with conventional dual axle systems. The independent trailing arm torsion suspension reduces shock recovery oscillation and trailer body roll on rough or uneven road surfaces.

Automotive Ceramic Insulation

Used to insulate the holding tanks and wheel wells of the Element, lightweight Delta T Automotive Ceramic Insulation is an advanced composition of high-grade acrylic binders with reflective and sound absorbing attributes. This proven aerospace material reduces heat transfer by 25-30 degrees and deadens noise by 10-12 decibels. The Delta T material also protects surfaces from moisture and corrosion. Water based, it has no out-gassing of VOCs making it a healthier choice for your entire family.

Clear Shield

An invisible stone guard material applied to the front of each Element, Clear Shield protects against stone chips, bug acid, winter salt, sand, road debris and scratches. Clear Shield is a nano-fusion paint protective film that installs easily as a clear adhesive sheet over the painted exterior. When applied over the painted surface, Clear Shield works onto the contours of the

surface and remains flexible. This flexibility allows it to compress and expand easily with the impact of road debris. Clear Shield is stain and UV resistant, easy to clean and provides superior protection without compromising the classic automotive styling of the Element.

Element One Ton Jack

The unique jack on your Element can be mounted in three different handle orientations—front, driver side, or passenger side. Seven-inch, twin-track wheels provide improved stability and traction on uneven surfaces.

Element Suspension System

Instead of leaf spring suspension, the Element utilizes independent trailing arm torsion suspension integrated with a through-chassis fixed beam axle. The suspension system is comprised of a specially shaped, outer axle beam profile interlocked with a trailing arm carrier with rubber chords. The chords are specifically designed and manufactured to provide the best balance of shock absorbing properties and durability. The chords and trailing arm carrier assemblies for each side of the axle do not connect to one another providing a fully independent suspension. The utilization of the through-chassis fixed beam axle design allows the center of gravity of the Element to be lowered while maintaining a zero degree trailing arm setting, thus improving roll stability without adversely affecting the performance of the suspension.

Exoshell Roof

The Element product line incorporates a unique roof construction which is lightweight yet durable enough to walk on for inspections and service. Same as all of the materials used to construct an Element, materials utilized in the roof panel are impervious to rot, moisture, mold, and mildew. The roof nests into the unitized FRP body and is provided with a continuous seal absent of leak prone corner laps or joints. A UV stabilized non-streaking waterproof membrane is bonded to a seamless structural skin to provide protection from rain, snow, ice, and sun.



THE *ELEMENT* of

- Sustainable, green composites last a lifetime – virtually free of rot, mold or mildew for a higher resale value.



- The CompositTek™ floor is unitized to the chassis that supports the walls and roof panel—all components work together to form one unitized body.



- The AFT (Advanced Fulcrum Tracking) axle system provides balanced stability for true tracking on the road.

- European styled windows are crafted of tinted acrylic to provide energy efficiency and privacy.

- Chose from four color schemes de



TIMBER STONE BROWN



VINTAGE RED

INSPIRATION

- The ExoShell roofing system provides a tough, ultra waterproof UV resistant barrier.
- The ultra aerodynamic exterior of the Element is designed for improved fuel economy and straight tracking down the road.



- Lightweight composites and aluminum reduce the tongue weight to allow towing with lighter vehicles.

signed for your personality.



CLEAR WATER BLUE



ARCTIC WHITE

- The interior appointments of the Element are clean, functional and ready for the rigors of today's most active family.

The Elements of Style



Standard Features

Construction

ComposiTek™ Construction, Interlocked HSLA Unitized Chassis, Independent Trailing Arm Suspension, Automotive Grade Electro Coating, AFT (Advanced Fulcrum Tracking) Axle Configuration, Wide Track Hubs, Nitrogen-Filled Balanced Tires

Element Exclusive Features

Unitized FRP Body Meets 60 Square Foot Frontal Area in Accordance with OEM Towing Guidelines, Ultra Low Drag Design in Accordance with OEM Towing Guidelines, Meets all State and Federal North American Highway Use Limitations, Enclosed Battery and LP Compartment with Marine Hatch, Custom-Fitted Storage Cover Available, Radius Corner Slide Room With Four Point Actuator, ExoShell Seamless Poly Roof

Interior

ComposiTek™ Hybrid Cabinetry with Concealed Hinges, Euro-Style Convertible Lounge Seating, Padded “No Crack” Vinyl Flooring Throughout, DVD/AM/FM/IPOD/USB Entertainment System With IPOD Dock, Radius Corner Hinged Mattress, True Queen Walk Around Bed (60” x 80”), Molded Bed Lid With Gas-Charged Lift Struts, Deep Bed Shelf at Head of Bed, Bedroom Prepped For 20” LCD TV, Bedroom Privacy Curtain, Bath Wall Mirror

Exterior

Entry Light, Exterior Prepped for 20” LCD TV, Oversized Lighted Exterior Pass-Thru Storage, 110v Exterior GFCI Receptacle, Radius Entry Door With Screen

Safety

Non-Combustible Panels in Kitchen, GAWR Exceeds GVWR, LED Exterior Step Light, CO/LP/Smoke Detectors, Fire Extinguisher, LP/Battery Compartment Firewall, Digital Slide Room Controller With Load Sensing Technology (Slide Models), Safety Glazed Mirrors in Bath, GFCI Protected Kitchen/Bath/Exterior Receptacles

Utilities

Lockable Centralized Utility Compartment, Cable/Satellite Input, Antifreeze Suction Line, Self Coiling Hose with Hot/Cold Water, Dual Tank LP Regulator With Auto-Changeover, City Water Inlet, Pressure Fresh Tank Fill, Black Tank Fill Indicator in Bathroom, Up to 60# LP Capacity, Dual Enclosed Battery Trays

Appliances and Fixtures

*SS Two Burner LP Cooktop With Folding Glass Cover, *SS Slim Profile Power Range Hood With Dual Lights, Living Area Vent Prepped for Rooftop AC, LP Quick-Disconnect (Gas Grill Ready), *SS Kitchen Sink, *SS Lavatory Sink, Foot Flush Toilet, Detachable Shower Hose, Black Tank Flush

Customer Satisfaction Package **

Aluminum Rims with ICF Technology, E-Z Lube Hubs, Grab Bar at Entry, Four Point Stabilizer Jacks With Extended Crank Handle, Two-tone Body Paint with Automotive Clear Coat Available in Four Custom Color Schemes, Color Coordinated Graphic Package, Soft Touch Padded Ceiling, LED Interior Lighting, Day/Night Window Shades, High Intensity LED Taillights and Clearance Lights With Chrome Accent, Living Area Prepped For 24" LCD TV, Coordinating Designer Mattress Cover, Privacy Tinted Dual Pane Arched Windows with Operable Screens, Awning, Exterior Speakers, 120 Watt Solar Panel Prep, External Tank Sensors, Black/Fresh/Grey Monitor Panel, AC/DC Power Center with Detachable Marine Cord, Omni-Directional Roof Mount TV/Radio HD Antenna, DVD/AM/FM/IPOD/USB Entertainment System With IPOD Dock, *SS 3-way (LP/AC/DC) Refrigerator with Freezer Compartment, *SS Microwave, Self Coiling Vinyl Coated Stainless Steel Aircraft-grade Safety Cables, 6 Gallon DSI Gas/Electric Dual Mode Water Heater, Pressure Demand Water Pump With Strainer, Power Vents in Bedroom/Bathroom, Detachable Shower Hose, Dual 20# Composite LP Bottles

Optional Packages

Appearance Group

Pillow Top True Queen (60" x 80") Hinged Mattress, 24" LCD TV With Detachable Swing Mount in Living Area, 16" Wheels, Fulton F2 Jack with Dual Casters, Removable Non-Skid Carpet Mats, Acrylic Front Panel, Lifetime Warranted Protective Front Paint Mask Shield, Custom Fitted Storage Cover

Cold Climate Camping Package

Ducted 25,000 BTU LP Furnace, Heated Holding Tanks, Ceramic Tank Insulation, Double Insulated Bulkhead

Solar Power Package

10 Watt Rooftop Solar Panel, Solar Charge Controller, 120 Watt Prep Lines, Dual Battery Boxes and Trays, Dual Mode Battery Switch, Interior Solar Controller Display Panel Prep Wire, Rooftop Panel Mounting Plate

Optional Features

Under Mount Spare Carrier With Spare Tire, 24" LCD TV With Detachable Swing Mount in Living Area, 20" LCD TV With Detachable Swing Mount in Bedroom, Power Awning, Custom Fitted Storage Cover, Woody Graphic Package, Water Filtration System, 13,500 BTU Low Profile Rooftop AC IPO Roof Vent, 15,000 BTU Low Profile Rooftop AC IPO Roof Vent, 10,500 BTU Heat Pump, Large Folding Grab Handle, High Capacity Power Vent IPO Roof Vent, Solid Surface Countertops Throughout, *SS Convection Microwave, Removable Wheel Covers, CSA Z240 Code Compliance and Certification, Euro Cartridge Toilet With Caddy, Additional Black Tank Cartridge Available

* SS-Stainless Steel

** On All Element Models

Element 24 Series Base Specs:

LOA	25'8"
Body Length	23'4"
Body Width	90"
Exterior Height	9'0"
Interior Height	84"
Mattress	60"x80"
GVWR	4,585
UVW	3,300
Hitch	395
Fresh	36
Grey	29
Black	29
LP	40-60
CCC	1,295

Element 26 Series Base Specs

LOA	28'2"
Body Length	25'10"
Body Width	90"
Exterior Height	9'0"
Interior Height	84"
Mattress	60"x80"
GVWR	5,290
UVW	3,995
Hitch	495
Fresh	36
Grey	29
Black	29
LP	40-60
CCC	1,295

* All weights are approximate
Every RV is weighed prior to shipping and its exact weight is provided with the trailer.

Floorplans

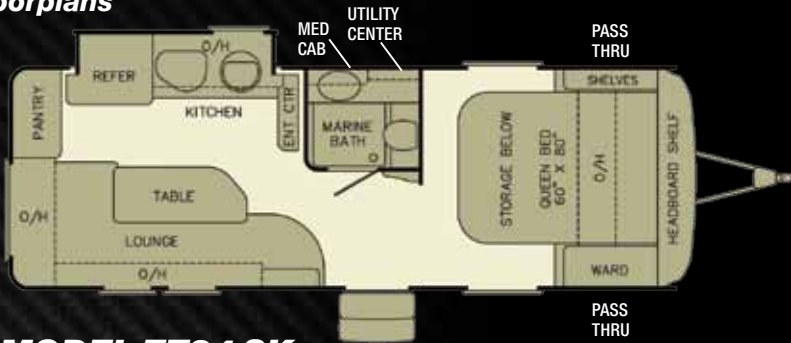

MODEL ET24 SK

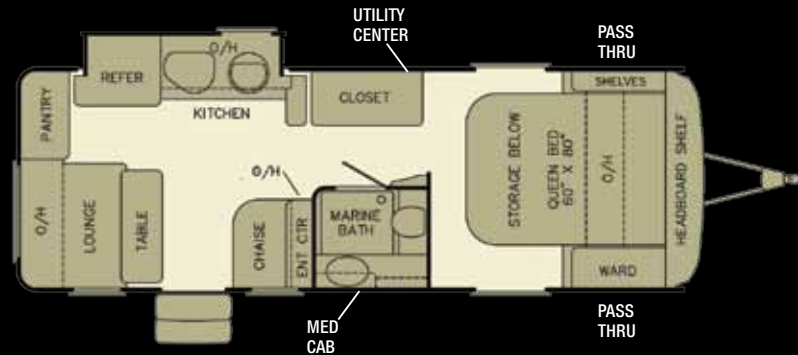

MODEL ET24 SW

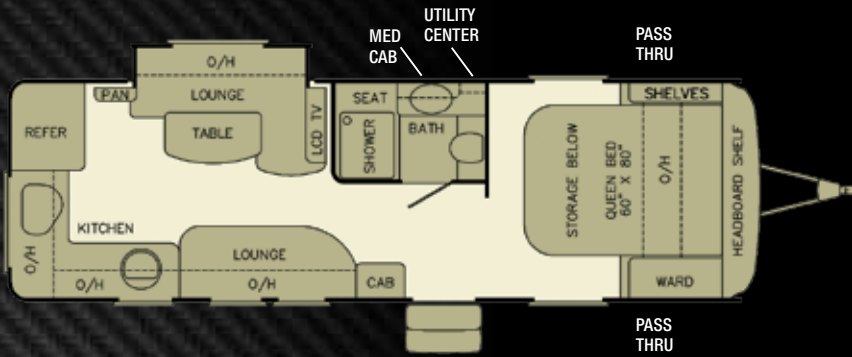

MODEL ET26 SRK

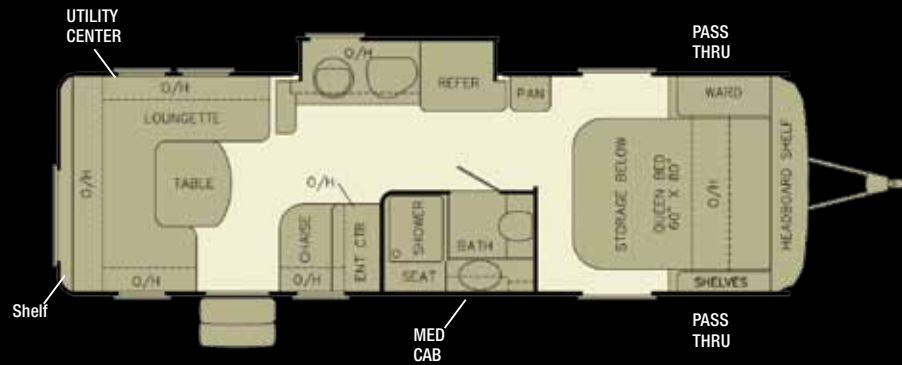

MODEL ET26 SRL

Your Authorized Element Dealer:



Element



CSA Z240 Code
Compliance and Certification

www.GoElementRV.com

10758 County Road 2 • Middlebury, IN 46540
Phone: (574) 825-4298 • Fax: (574) 825-4299
www.GoEverGreenRV.com

