



DEALER REFERENCE GUIDE

GT54	60 Motor Yacht
GT60	72 Motor Yacht
GT63	80 Motor Yacht
64 Convertible	100 Motor Yacht
68 Convertible	
77 Convertible	



GT54

Specifications

Length Overall	53'10"
Length Overall with bow Pulpit	57'2"
Beam	17'3"
Draft	4'2"
Freeboard Forward	6'6"
Freeboard Aft	3'2"
Headroom Most Areas	6'6"
Freshwater Capacity	180 gallons
Fuel Capacity	1,200 gallons
Holding Capacity95 gallons
Weight Displacement	75,000 pounds
Height above waterline	14'8"
Waterline Length	47'7"

Engines

CAT C18A	1150 BHP
CAT C32A	1600 BHP

Hatteras GT
SERIES

GT54 Arrangement

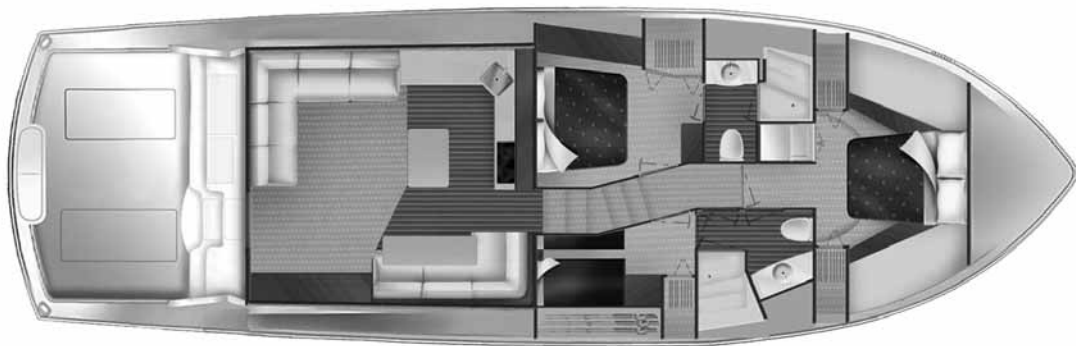

Hatteras GT54

Standard Fuel

1200 Gallons / 4542 Liters

Displacement

75,000 lbs. / 34,019 Kilos Full Load

Fuel consumption is based on two (2) engines at any given RPM.

Speed and ranges are estimates based on engineering calculations. Range is based on 95% of standard fuel capacity. Actual performance will vary and be affected by water and weather conditions, load and conditions of boat, engines, and propellers. Speed will increase as fuel is consumed. All data is illustrative and is not warranted.

Performance Data

1

Engines: (2) CATERPILLAR C18 ACERT

Rated @ 1150 BHP @ 2300 RPM's

RPM	SPEED (KNOTS)	FUEL CONS. (ENGINES ONLY)	RANGE NAUT. MI. (ENGINES)	HOURS @ SPEED
2300	34-36	120	333	9.5
2100	30-32	90	393	12.7
2000	28-30	81	408	14.1
1800	24-26	62	460	18.4

Hatteras GT54

Standard Fuel
1200 Gallons / 4542 Liters

Displacement
75,000 lbs. / 34,019 Kilos Full Load

Fuel consumption is based on two (2) engines at any given RPM.

Speed and ranges are estimates based on engineering calculations. Range is based on 95% of standard fuel capacity. Actual performance will vary and be affected by water and weather conditions, load and conditions of boat, engines, and propellers. Speed will increase as fuel is consumed. All data is illustrative and is not warranted.

Performance Data 2

Engines: (2) CATERPILLAR C32 ACERT Rated @ 1600 BHP @ 2300 RPM's

RPM	SPEED (KNOTS)	FUEL CONS. (ENGINES ONLY)	RANGE NAUT. MI. (ENGINES)	HOURS @ SPEED
2300	40-42	170	275	6.7
2100	37-39	122	355	9.3
2000	35-37	110	373	10.4
1800	32-34	93	405	12.3

Standards

Cockpit

- Bait & tackle center w/ gaff storage
- Mezzanine seating with arm rest
- Drink box & wet storage box in steps
- Freezer and ice bin in mezzanine
- In-transom livewell option available
- Twin in-sole fishboxes

Flybridge

- Peninsula helm standard

Standard Interior Offerings

- Satin Cherry
- Satin Mahogany

Optional "GT Design Series" Interior

- Satin Cherry, raised panel cabinetry throughout
- "Free standing" furniture appearance
- Custom moldings and design features
- Upgraded Fabrics

Interior Features

- 3 Stateroom / 2 Head arrangement
- Open salon/galley layout – 270 degree visibility
- Salon complete with L-shaped sectional and premium audio/visual components
- Island galley with under counter drawer style refrigeration and freezer
- Wainscoting throughout the lower companionway
- Master stateroom with walk around queen berth
- VIP stateroom forward w/queen arrangement or optional over under berths
- Bunkroom, side-by-side berth arrangement with rod storage

Custom Offerings

- "High gloss" interior finish
- Exotic wood selections
- Contemporary interior design
- Custom Layouts

**2 Year Limited Warranty,
10 Year Hull Warranty**

GT54 Tank Location & Volume

Water Tank
180 Gallons

Fuel Tank
1200 Gallons

Holding Tank
95 Gallons

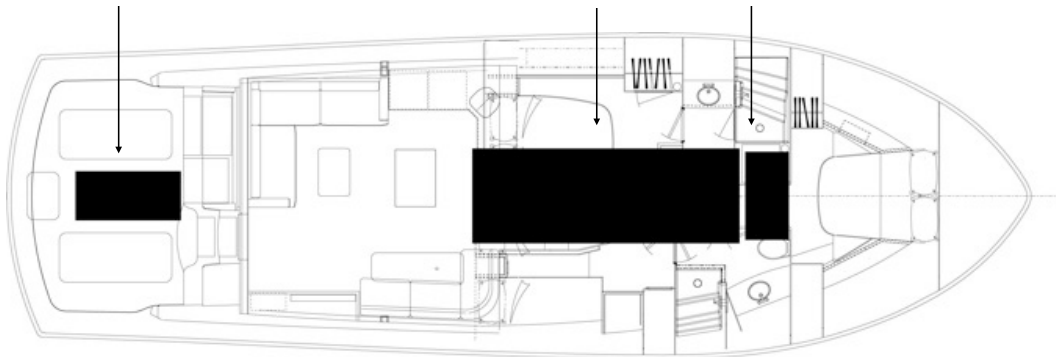



GT60

Specifications

Length Overall	59'10"
Length Overall with bow Pulpit	62'2"
Beam	19'0"
Draft	4'9"
Freeboard Forward	7'8"
Freeboard Aft	3'0"
Headroom Most Areas	6'6"
Freshwater Capacity	200 gallons
Fuel Capacity	1,500 gallons
Optional Fuel Capacity	1,750 gallons
Holding Capacity	100 gallons
Weight Displacement	89,500 pounds
Height above waterline to:	
Top of Flybridge	15'
Top of Enclosed Flybridge	18'9"
Waterline Length	51'11"

Engines

CAT C32A	1600 BHP
CAT C32A	1800 BHP
CAT C32A	1900 BHP

Hatteras GT
SERIES

GT60 Arrangements

3 Stateroom, 3 Head Arrangement

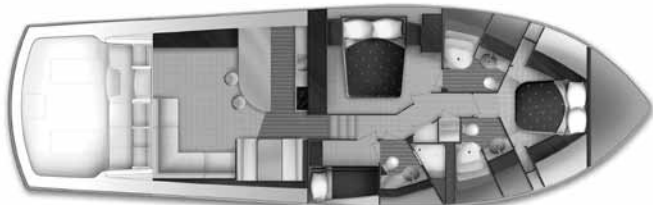

Optional V Berth Arrangement

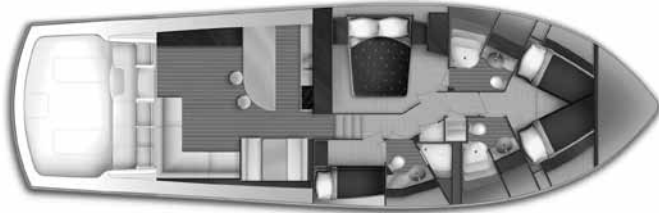

4 Stateroom, 3 Head Arrangement

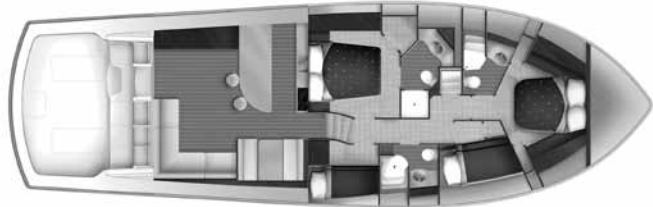

Optional Galley Down w/Bow Crew Arrangement

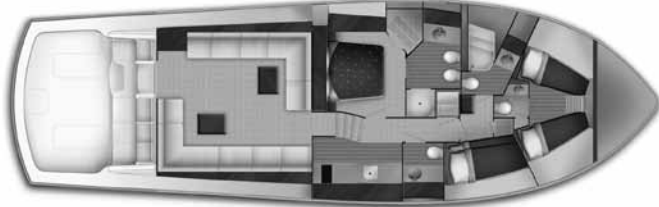

GT60 Arrangements

Center Console Flybridge Arrangement



Optional Flybridge Arrangement



Enclosed Flybridge Arrangement

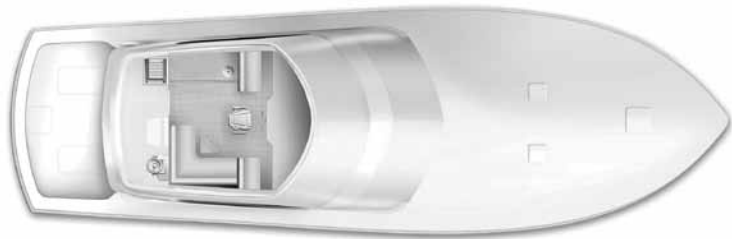

Hatteras GT60

Standard Fuel

1500 Gallons / 5,678 Liters

Displacement

89,500 lbs. / 40,596 Kilos Full Load

Fuel consumption is based on two (2) engines at any given RPM.

Speed and ranges are estimates based on engineering calculations. Range is based on 95% of standard fuel capacity. Actual performance will vary and be affected by water and weather conditions, load and conditions of boat, engines, and propellers. Speed will increase as fuel is consumed. All data is illustrative and is not warranted.

Performance Data

1

Engines: (2) CATERPILLAR C32 ACERT

Rated @ 1600 BHP @ 2300 RPM's

RPM	SPEED (KNOTS)	FUEL CONS. (ENGINES ONLY)	RANGE NAUT. MI. (ENGINES)	HOURS @ SPEED
2300	36-38	155	340	9.2
2100	32-34	126	377	11.3
2000	30-32	113	391	12.6
1800	26-28	89	432	16.0

Performance Data

2

Standard Fuel

1500 Gallons / 5,678 Liters

Displacement

89,500 lbs. / 40,596 Kilos Full Load

Fuel consumption is based on two (2) engines at any given RPM.

Speed and ranges are estimates based on engineering calculations. Range is based on 95% of standard fuel capacity. Actual performance will vary and be affected by water and weather conditions, load and conditions of boat, engines, and propellers. Speed will increase as fuel is consumed. All data is illustrative and is not warranted.

Engines: (2) CATERPILLAR C32 ACERT

Rated @ 1800 BHP @ 2300 RPM's

RPM	SPEED (KNOTS)	FUEL CONS. (ENGINES ONLY)	RANGE NAUT. MI. (ENGINES)	HOURS @ SPEED
2300	39-41	175	326	8.1
2100	35-37	142	361	10.0
2000	33-35	127	381	11.2
1800	29-31	100	428	14.3

Hatteras GT60

Standard Fuel

1500 Gallons / 5,678 Liters

Displacement

89,500 lbs. / 40,596 Kilos Full Load

Fuel consumption is based on two (2) engines at any given RPM.

Speed and ranges are estimates based on engineering calculations. Range is based on 95% of standard fuel capacity. Actual performance will vary and be affected by water and weather conditions, load and conditions of boat, engines, and propellers. Speed will increase as fuel is consumed. All data is illustrative and is not warranted.

Performance Data

3

Engines: (2) CATERPILLAR C32 ACERT

Rated @ 1900 BHP @ 2300 RPM's

RPM	SPEED (KNOTS)	FUEL CONS. (ENGINES ONLY)	RANGE NAUT. MI. (ENGINES)	HOURS @ SPEED
2300	40-42	185	316	7.7
2100	36-38	151	349	9.4
2000	34-36	135	369	10.6
1800	30-32	107	413	13.3

GT60 Tank Location & Volume

Water Tank
200 Gallons

Fuel Tank (*Optional*)
250 Gallons

Fuel Tank
1500 Gallons

Holding Tank
100 Gallons

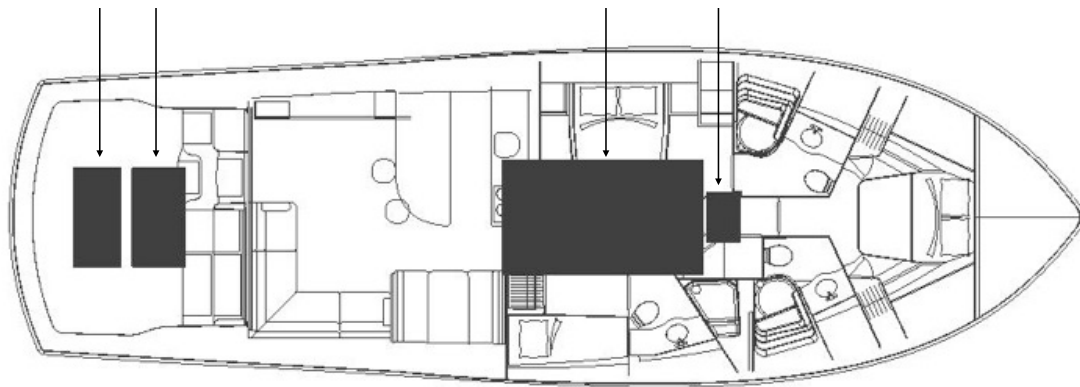

Standards

Cockpit

- Bait & tackle center w/ gaff storage
- Mezzanine seating with arm rest
- Refrigerated drink box and wet storage box in steps
- Freezer and ice bin in mezzanine
- In-transom livewell option available
- Twin in-sole fishboxes

Flybridge

- Center console helm standard
- Peninsula console helm optional
- Enclosed Flybride

Standard Interior Offerings

- Satin Cherry
- Satin Mahogany

Optional “GT Design Series” Interior

- Satin Cherry, raised panel cabinetry throughout
- “Free standing” furniture appearance
- Custom moldings and design features
- Upgraded Fabrics

Custom Offerings

- “High gloss” interior finish
- Exotic wood selections
- Contemporary interior design

Interior Features

- 3 Stateroom / 3 Head arrangement
- Open salon/galley layout – 270 degree visibility

- Salon complete with L-shaped sectional and premium audio/visual components
- Galley with booth style dinette and two (2) bar stools for extra galley seating
- Under counter drawer style refrigeration
- Decorative wood accents in the salon with wainscoting throughout the lower companionway
- Master stateroom with walk around queen berth with private entrance to ensuite head
- VIP stateroom forward with queen berth or optional over and under arrangement
- Over and under bunkroom arrangement
- Optional 4th stateroom layout

**2 Year Limited Warranty,
10 Year Hull Warranty**



GT63

Specifications

Length Overall	63'10"
Length Overall with bow Pulpit	66'11"
Beam	20'
Draft	5'
Freeboard Forward	8'7"
Freeboard Aft	3'6"
Headroom Most Areas	6'6"
Freshwater Capacity	270 gallons
Fuel Capacity	1,900 gallons
Holding Capacity	150 gallons
Weight Displacement	102,000 pounds
Height above waterline	15'8"
Top of Enclosed Flybridge	19'5"
Waterline Length	56'5"

Engines

CAT C32A	1600 BHP
CAT C32A	1800 BHP
CAT C32A	1900 BHP

Hatteras GT
SERIES

GT63 Arrangements

4 Stateroom, 3 Head Arrangement

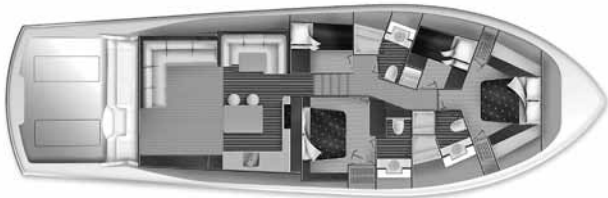

3 Stateroom, 3 Head w/Office Arrangement



Optional Galley Down w/Crew Arrangement

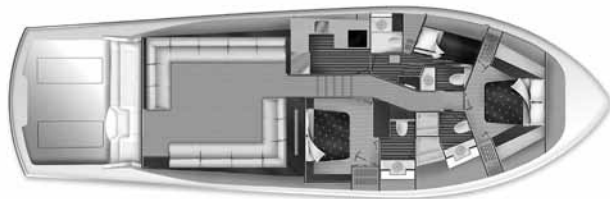

GT63 Arrangements

Center Console Flybridge Arrangement



Optional Flybridge Arrangement



Optional Enclosed Flybridge Arrangement



Hatteras GT63

Standard Fuel

1900 Gallons / 6,814 Liters

Displacement

102,000 lbs. / 46,266 Kilos Full Load

Fuel consumption is based on two (2) engines at any given RPM.

Speed and ranges are estimates based on engineering calculations. Range is based on 95% of standard fuel capacity. Actual performance will vary and be affected by water and weather conditions, load and conditions of boat, engines, and propellers. Speed will increase as fuel is consumed. All data is illustrative and is not warranted.

Performance Data

1

Engines: (2) CATERPILLAR C32 ACERT

Rated @ 1600 BHP @ 2300 RPM's

RPM	SPEED (KNOTS)	FUEL CONS. (ENGINES ONLY)	RANGE NAUT. MI. (ENGINES)	HOURS @ SPEED
2300	35-37	160	406	11.3
2100	31-33	142	407	12.7
2000	29-31	129	420	14.0
1800	25-27	100	469	18.1

Hatteras GT63

Standard Fuel

1900 Gallons / 6,814 Liters

Displacement

102,000 lbs. / 46,266 Kilos Full Load

Fuel consumption is based on two (2) engines at any given RPM.

Speed and ranges are estimates based on engineering calculations. Range is based on 95% of standard fuel capacity. Actual performance will vary and be affected by water and weather conditions, load and conditions of boat, engines, and propellers. Speed will increase as fuel is consumed. All data is illustrative and is not warranted.

Performance Data

2

Engines: (2) CATERPILLAR C32 ACERT

Rated @ 1800 BHP @ 2300 RPM's

RPM	SPEED (KNOTS)	FUEL CONS. (ENGINES ONLY)	RANGE NAUT. MI. (ENGINES)	HOURS @ SPEED
2300	38-40	185	381	9.8
2100	34-36	158	400	11.4
2000	32-34	141	422	12.8
1800	28-30	110	476	16.4

Hatteras GT63

Standard Fuel

1900 Gallons / 6,814 Liters

Displacement

102,000 lbs. / 46,266 Kilos Full Load

Fuel consumption is based on two (2) engines at any given RPM.

Speed and ranges are estimates based on engineering calculations. Range is based on 95% of standard fuel capacity. Actual performance will vary and be affected by water and weather conditions, load and conditions of boat, engines, and propellers. Speed will increase as fuel is consumed. All data is illustrative and is not warranted.

Performance Data

3

Engines: (2) CATERPILLAR C32 ACERT

Rated @ 1900 BHP @ 2300 RPM's

RPM	SPEED (KNOTS)	FUEL CONS. (ENGINES ONLY)	RANGE NAUT. MI. (ENGINES)	HOURS @ SPEED
2300	39-41	195	370	9.3
2100	35-37	170	382	10.6
2000	33-35	154	399	11.7
1800	29-31	125	433	14.4

GT63 Tank Location & Volume

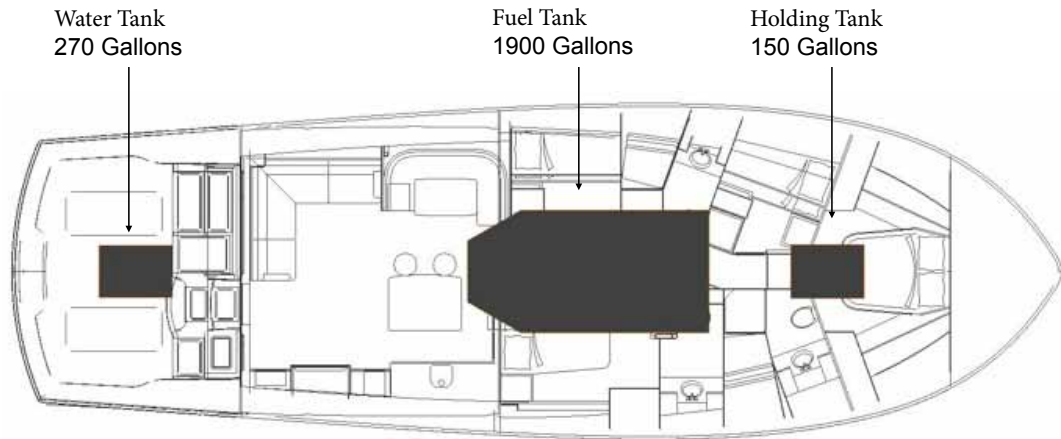

Standards

Cockpit

- Bait & tackle center w/ gaff storage
- Mezzanine seating with arm rest
- Refrigerated drink box and wet storage box in steps
- Freezer and ice bin in mezzanine
- In-transom livewell option available
- Twin in-sole fishboxes

Flybridge

- Center console helm standard
- Peninsula console helm optional
- Freezer storage

Standard Interior Offerings

- Satin Cherry
- Satin Mahogany

Optional “GT Design Series” Interior

- Satin Cherry, raised panel cabinetry

throughout

- “Free standing” furniture appearance
- Custom moldings and design features
- Upgraded Fabrics

Custom Offerings

- “High gloss” interior finish
- Exotic wood selections
- Contemporary interior design
- Custom layouts

Interior Features

- 4 Stateroom / 3 Head arrangement - Standard
- Expansive salon/galley layout – 270 degree visibility
- Island galley with under counter drawer style refrigeration and freezer
- U-shaped dinette and two (2) barstools for

extra galley seating

- Salon complete with large L-shaped sectional and premium audio/visual components
- Decorative wood accents in the salon with wainscoting throughout the lower companionway
- Furniture quality corner moldings and design features
- Master stateroom accommodations with walk around queen berth
- VIP stateroom forward with ample floor space and ensuite head
- Port bunkroom standard with over under bunks – Pullman berth

**2 Year Limited Warranty,
10 Year Hull Warranty**



64 CONVERTIBLE

Specifications

Length Overall	63'10"
Length Overall with bow Pulpit	67'2"
Beam	19'6"
Draft	4'10"
Freeboard Forward	7'7"
Freeboard Aft	3'1"
Headroom Most Areas	6'6"
Freshwater Capacity	343 gallons
Fuel Capacity	1,950 gallons
Holding Capacity	105 gallons
Weight Displacement	115,000 pounds
Height above waterline to:	
Top of Flybridge	15'3"
Top of Enclosed . Flybridge	19'3"
Waterline Length	55'11"

Engines

CAT C32 (standard)	1550 BHP
CAT C32	1650 BHP
CAT C32A	1800 BHP
MTU 10V2000 CR	1500 BHP



64C Arrangements

Flybridge Arrangement



Standard Salon and Galley

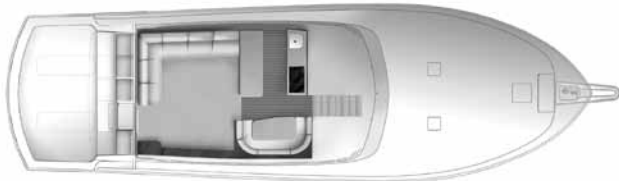

Enclosed Flybridge



64C Arrangements

Standard Arrangement

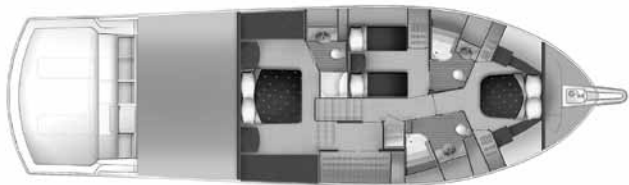

4 Stateroom, 3 Head

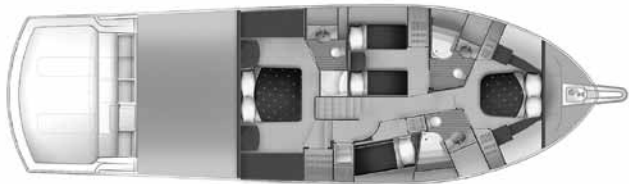

Optional Bow Arrangement

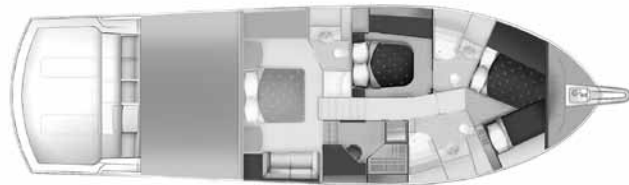

Hatteras 64 Convertible

Standard Fuel

1950 Gallons / 7,381 Liters

Displacement

115,000 lbs. / 52,163 Kilos Full Load

Fuel consumption is based on two (2) engines at any given RPM.

Speed and ranges are estimates based on engineering calculations. Range is based on 95% of standard fuel capacity. Actual performance will vary and be affected by water and weather conditions, load and conditions of boat, engines, and propellers. Speed will increase as fuel is consumed. All data is illustrative and is not warranted.

Performance Data

1

Engines: (2) C32 CATERPILLAR DIESELS

Rated @ 1550 BHP @ 2300 RPM's

RPM	SPEED (KNOTS)	FUEL CONS. (ENGINES ONLY)	RANGE NAUT. MI. (ENGINES)	HOURS @ SPEED
2300	27-29	166	312	11.3
2100	24-26	126	367	14.9
2000	22-24	114	374	16.5
1800	20-22	90	432	20.9

Engines: (2) C32 CATERPILLAR DIESELS

Rated @ 1650 BHP @ 2300 RPM's

RPM	SPEED (KNOTS)	FUEL CONS. (ENGINES ONLY)	RANGE NAUT. MI. (ENGINES)	HOURS @ SPEED
2300	28-30	172	312	10.9
2100	25-27	132	365	14.3
2000	23-25	120	370	15.7
1800	20-22	96	405	19.6

**The above performance numbers are reflective of open flybridge models only.*

Hatteras 64 Convertible

Standard Fuel

1950 Gallons / 7,381 Liters

Displacement

115,000 lbs. / 52,163 Kilos Full Load

Fuel consumption is based on two (2) engines at any given RPM.

Speed and ranges are estimates based on engineering calculations. Range is based on 95% of standard fuel capacity. Actual performance will vary and be affected by water and weather conditions, load and conditions of boat, engines, and propellers. Speed will increase as fuel is consumed. All data is illustrative and is not warranted.

Performance Data

2

Engines: (2) C32 ACERT CATERPILLAR DIESELS Rated @ 1800 BHP @ 2300 RPM's

RPM	SPEED (KNOTS)	FUEL CONS. (ENGINES ONLY)	RANGE NAUT. MI. (ENGINES)	HOURS @ SPEED
2300	32-34	188	325	10.0
2100	29-31	142	391	13.2
2000	27-29	130	399	14.5
1800	24-26	106	437	17.7

Engines: (2) 10V2000CR MTU DIESELS Rated @ 1500 BHP @ 2450 RPM's

RPM	SPEED (KNOTS)	FUEL CONS. (ENGINES ONLY)	RANGE NAUT. MI. (ENGINES)	HOURS @ SPEED
2450	27-29	158	328	11.9
2200	24-26	120	386	15.7
2100	22-24	110	387	17.1
2000	21-23	90	453	20.9
1800	19-21	82	452	22.9

**The above performance numbers are reflective of open flybridge models only.*

Standards

- Solid fiberglass hull bottom
- PVC foam core in hull sides
- Painted Exterior
- Forced Air Induction System
- Icom VHF
- Furuno RD30 depth and temp
- 164 square foot cockpit
- 17 square feet of mezzanine seating in cockpit
- 10 cubic foot freezer in upper mezzanine
- 27.5kW Onan generator
- 42" TV in Salon
- 166 square foot full beam master stateroom
- **2 Year Limited, 10 Year Hull Warranty**



64C Tank Location & Volume

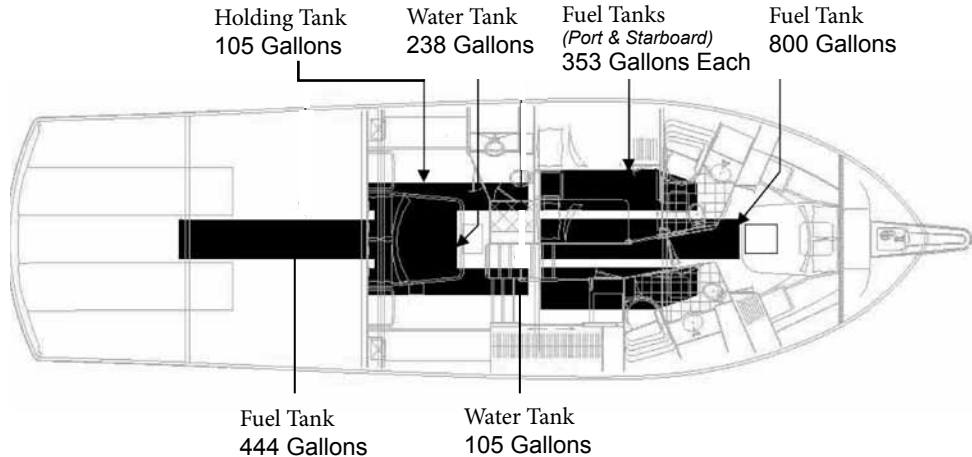



68 CONVERTIBLE

Specifications

Length Overall	68'6"
Length Overall with bow Pulpit . . .	71'10"
Beam	21'6"
Draft	5'3"
Freeboard Forward	7'10"
Freeboard Aft	3'1"
Headroom Most Areas	6'6"
Freshwater Capacity	400 gallons
Fuel Capacity	2,100 gallons
Holding Capacity	125 gallons
Weight Displacement . . .	140,000 pounds
Height above waterline to:	
Top of Flybridge	15'1"
Top of Enclosed . Flybridge	19'2"
Waterline Length	59'9"

Engines

CAT C32A	1600 BHP
CAT C32A	1800 BHP
CAT C32A	1900 BHP
MTU 16V2000	2000 BHP
MTU 16V2000 CR	2400 BHP



68C Arrangements

Standard Lower Deck Arrangement

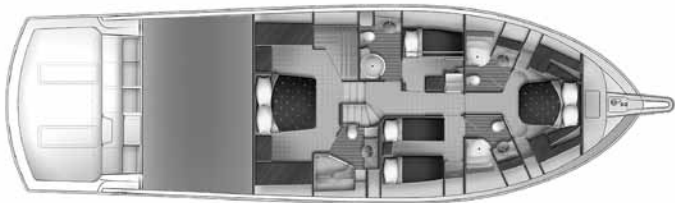

Optional Stateroom Arrangement

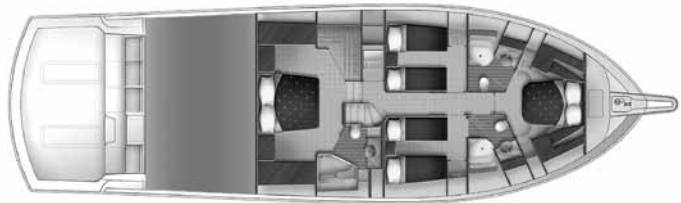

68C Arrangements

Flybridge Arrangement



Standard Upper Deck Arrangement

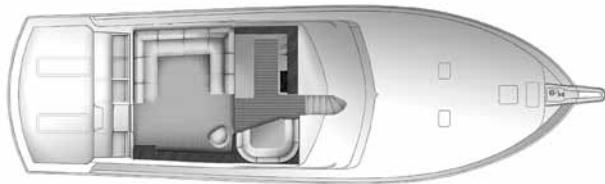

Enclosed Flybridge

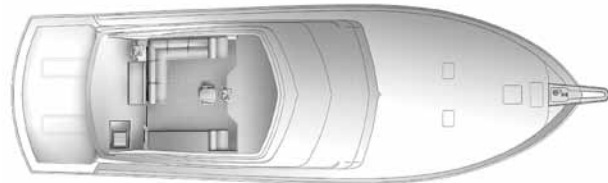

Standards

- Solid fiberglass hull bottom
- Painted Exterior
- PVC foam core in hull sides
- 2 Year Limited, 10 Year Hull Warranty
- Forced Air Induction System
- Furuno RD30 depth and temp
- Icom VHF
- Northstar 6101i GPS/Plotter
- Simrad autopilot
- 192 square foot cockpit
- 25 square feet of mezzanine seating in cockpit
- 10 cubic foot freezer in upper mezzanine
- Two 50 amp retractable shore cords
- Two 27.5 kW Onan generators
- 42" TV in salon
- Central vacuum
- Full beam master stateroom
- **2 Year Limited, 10 Year Hull Warranty**



Hatteras 68 Convertible

Standard Fuel

2100 Gallons / 7,949 Liters

Displacement

140,000 lbs. / 63,503 Kilos Full Load

Fuel consumption is based on two (2) engines at any given RPM.

Speed and ranges are estimates based on engineering calculations. Range is based on 95% of standard fuel capacity. Actual performance will vary and be affected by water and weather conditions, load and conditions of boat, engines, and propellers. Speed will increase as fuel is consumed. All data is illustrative and is not warranted.

Performance Data

1

Engines: (2) C32 CATERPILLAR DIESELS Rated @ 1600 BHP @ 2300 RPM's

RPM	SPEED (KNOTS)	FUEL CONS. (ENGINES ONLY)	RANGE NAUT. MI. (ENGINES)	HOURS @ SPEED
2300	28-30	172	336	11.6
2100	25-27	134	387	14.9
2000	24-26	122	409	16.4
1800	22-24	98	468	20.4

Engines: (2) C32 ACERT CATERPILLAR DIESELS Rated @ 1800 BHP @ 2300 RPM's

RPM	SPEED (KNOTS)	FUEL CONS. (ENGINES ONLY)	RANGE NAUT. MI. (ENGINES)	HOURS @ SPEED
2300	32-34	188	350	10.6
2100	29-31	150	399	13.3
2000	27-29	134	417	14.9
1800	24-26	104	480	19.2

**The above performance numbers are reflective of open flybridge models only.*

Hatteras 68 Convertible

Standard Fuel

2100 Gallons / 7,949 Liters

Displacement

140,000 lbs. / 63,503 Kilos Full Load

Fuel consumption is based on two (2) engines at any given RPM.

Speed and ranges are estimates based on engineering calculations. Range is based on 95% of standard fuel capacity. Actual performance will vary and be affected by water and weather conditions, load and conditions of boat, engines, and propellers. Speed will increase as fuel is consumed. All data is illustrative and is not warranted.

Performance Data

2

Engines: (2) C32 CATERPILLAR DIESELS Rated @ 1900 BHP @ 2300 RPM's

RPM	SPEED (KNOTS)	FUEL CONS. (ENGINES ONLY)	RANGE NAUT. MI. (ENGINES)	HOURS @ SPEED
2300	33-35	198	343	10.1
2100	30-32	160	387	12.5
2000	28-30	140	413	14.3
1800	25-27	110	472	18.1

Engines: (2) 16V2000 MTU DIESELS Rated @ 2000 BHP @ 2350 RPM's

RPM	SPEED (KNOTS)	FUEL CONS. (ENGINES ONLY)	RANGE NAUT. MI. (ENGINES)	HOURS @ SPEED
2350	33-35	202	336	9.9
2100	29-31	152	394	13.1
2000	27-29	138	405	14.5
1800	23-25	114	420	17.5

**The above performance numbers are reflective of open flybridge models only.*

Hatteras 68 Convertible

Standard Fuel
2100 Gallons / 7,949 Liters

Displacement
140,000 lbs. / 63,503 Kilos Full Load

Fuel consumption is based on two (2) engines at any given RPM.

Speed and ranges are estimates based on engineering calculations. Range is based on 95% of standard fuel capacity. Actual performance will vary and be affected by water and weather conditions, load and conditions of boat, engines, and propellers. Speed will increase as fuel is consumed. All data is illustrative and is not warranted.

Performance Data

3

Engines: (2) 16V2000CR MTU DIESELS Rated @ 2400 BHP @ 2450 RPM's

RPM	SPEED (KNOTS)	FUEL CONS. (ENGINES ONLY)	RANGE NAUT. MI. (ENGINES)	HOURS @ SPEED
2450	35-37	244	294	8.2
2200	32-34	213	309	9.4
2100	30-32	193	320	10.3
2000	28-30	172	336	11.6
1800	25-27	130	399	15.3

**The above performance numbers are reflective of open flybridge models only.*

68C Tank Location & Volume

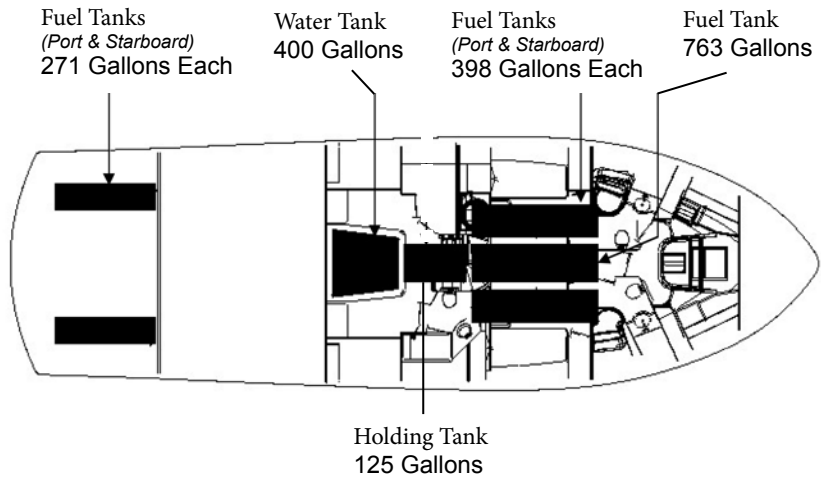



77 CONVERTIBLE

Specifications

Length Overall	76'10"
Length Overall with bow Pulpit	80'2"
Beam	22'0"
Draft	5'3"
Freeboard Forward	8'11"
Freeboard Aft	3'5"
Headroom Most Areas	6'6"
Freshwater Capacity	380 gallons
Fuel Capacity	3,000 gallons
Holding Capacity	200 gallons
Weight Displacement	175,000 pounds
Height above waterline to:	
Top of Enclosed . Flybridge	20'0"
Waterline Length	66'0"

Engines

CAT C32A (standard)	1800 BHP
CAT C32A	1900 BHP
MTU 16V2000	2000 BHP
MTU 16V2000 CR	2400 BHP
MTU 16V2000 CR	2600 BHP



77C Arrangements

Standard Arrangement

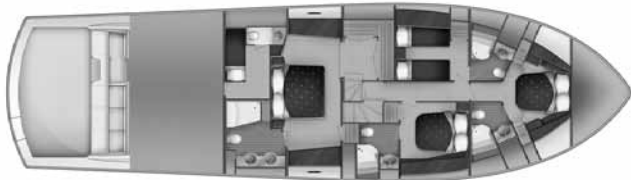

4 Stateroom, 4 Head



4 Stateroom, 4 Head w/His/Hers Master Haeed

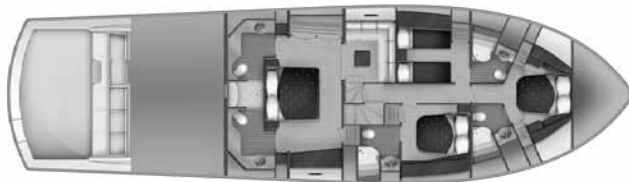

77C Arrangements

Flybridge Arrangement



Standard Upper Deck Arrangement

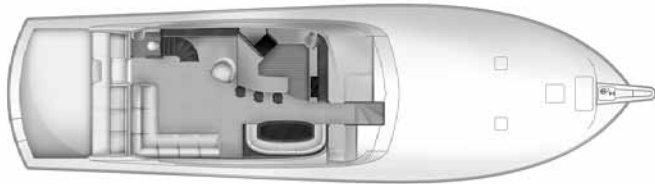

Optional Salon

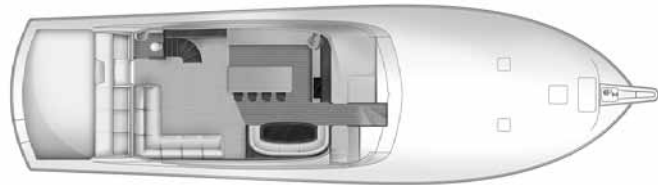

Hatteras 77 Convertible

Standard Fuel
3000 Gallons / 11,356 Liters

Displacement
175,000 lbs. / 79,379 Kilos Full Load

Fuel consumption is based on two (2) engines at any given RPM.

Speed and ranges are estimates based on engineering calculations. Range is based on 95% of standard fuel capacity. Actual performance will vary and be affected by water and weather conditions, load and conditions of boat, engines, and propellers. Speed will increase as fuel is consumed. All data is illustrative and is not warranted.

Performance Data

1

Engines: (2) C32 ACERT CATERPILLAR DIESELS Rated @ 1800 BHP @ 2300 RPM's

RPM	SPEED (KNOTS)	FUEL CONS. (ENGINES ONLY)	RANGE NAUT. MI. (ENGINES)	HOURS @ SPEED
2300	25-27	188	394	15.2
2100	22-24	150	437	19.0
2000	20-22	134	447	21.3
1800	17-19	104	493	27.4

Engines: (2) C32 ACERT CATERPILLAR DIESELS Rated @ 1900 BHP @ 2300 RPM's

RPM	SPEED (KNOTS)	FUEL CONS. (ENGINES ONLY)	RANGE NAUT. MI. (ENGINES)	HOURS @ SPEED
2300	26-28	198	389	14.4
2100	23-25	160	428	17.8
2000	21-23	140	448	20.4
1800	18-20	110	492	25.9

Hatteras 77 Convertible

Standard Fuel

3000 Gallons / 11,356 Liters

Displacement

175,000 lbs. / 79,379 Kilos Full Load

Fuel consumption is based on two (2) engines at any given RPM.

Speed and ranges are estimates based on engineering calculations. Range is based on 95% of standard fuel capacity. Actual performance will vary and be affected by water and weather conditions, load and conditions of boat, engines, and propellers. Speed will increase as fuel is consumed. All data is illustrative and is not warranted.

Performance Data

2

Engines: (2) 16V2000 MTU DIESELS

Rated @ 2000 BHP @ 2350 RPM's

RPM	SPEED (KNOTS)	FUEL CONS. (ENGINES ONLY)	RANGE NAUT. MI. (ENGINES)	HOURS @ SPEED
2350	27-29	202	395	14.1
2100	23-25	152	450	18.8
2000	21-23	138	454	20.7
1800	20-22	114	475	25.0

Engines: (2) 16V2000CR MTU DIESELS

Rated @ 2400 BHP @ 2450 RPM's

RPM	SPEED (KNOTS)	FUEL CONS. (ENGINES ONLY)	RANGE NAUT. MI. (ENGINES)	HOURS @ SPEED
2450	31-33	244	374	11.7
2200	27-29	213	375	13.4
2100	25-27	193	384	14.8
2000	23-25	172	398	16.6
1800	21-23	130	482	21.9

Hatteras 77 Convertible

Standard Fuel

3000 Gallons / 11,356 Liters

Displacement

175,000 lbs. / 79,379 Kilos Full Load

Fuel consumption is based on two (2) engines at any given RPM.

Speed and ranges are estimates based on engineering calculations. Range is based on 95% of standard fuel capacity. Actual performance will vary and be affected by water and weather conditions, load and conditions of boat, engines, and propellers. Speed will increase as fuel is consumed. All data is illustrative and is not warranted.

Performance Data

3

Engines: (2) 16V2000CR MTU DIESELS Rated @ 2600 BHP @ 2450 RPM's

RPM	SPEED (KNOTS)	FUEL CONS. (ENGINES ONLY)	RANGE NAUT. MI. (ENGINES)	HOURS @ SPEED
2450	33-35	278	349	10.3
2200	30-32	244	362	11.7
2100	28-30	218	379	13.1
2000	26-28	196	393	14.5
1800	23-25	156	438	18.3

Standards

- Solid fiberglass hull bottom
- PVC foam core in hull sides
- Painted Exterior
- Forced Air Induction System
- Standard Enclosed Bridge
- Ethernet Monitoring System with LCD touchpad
- Icom VHF
- Furuno RD30 depth and temp
- Northstar 6101i GPS/Plotter
- Simrad autopilot
- 192 square foot cockpit
- 25 square feet of mezzanine seating in cockpit
- 10 cubic foot freezer in upper mezzanine
- Two 100 amp retractable shore cords
- Two 27.5 kW Onan generators
- 46" TV in salon
- Day Head in salon
- 42" upright Sub-Zero refrigerator/freezer in galley
- Walk-in laundry room and pantry
- **2 Year Limited, 10 Year Hull Warranty**



77C Tank Location & Volume

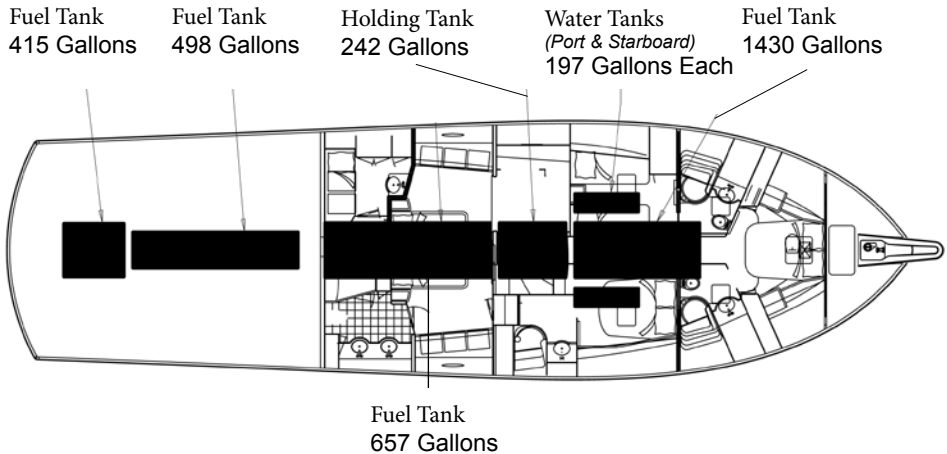



60 MOTOR YACHT

Specifications

Length Overall	60'11"
Beam	18'2"
Draft	4'6"
Freeboard Forward	6'11"
Freeboard Aft	5'3"
Headroom Most Areas	6'8"
Freshwater Capacity	250 gallons
Fuel Capacity	1000 gallons
Holding Capacity	100 gallons
Weight Displacement	87,700 pounds
Height above waterline:	
Top of windshield.	15'0"
Top of arch	19'9"
Waterline Length	53'1"

Engines

CAT C18A	1000 BHP
CAT C18A	1135 BHP



60MY Arrangements

Standard Upper Deck Arrangement



Standard Stateroom Arrangement



Flybridge Arrangement



Hatteras 60 Motor Yacht

Standard Fuel

1000 Gallons / 3,785 Liters

Displacement

87,700 lbs. / 39,780 Kilos Full Load

Fuel consumption is based on two (2) engines at any given RPM.

Speed and ranges are estimates based on engineering calculations. Range is based on 95% of standard fuel capacity. Actual performance will vary and be affected by water and weather conditions, load and conditions of boat, engines, and propellers. Speed will increase as fuel is consumed. All data is illustrative and is not warranted.

Performance Data

1

Engines: (2) CATERPILLAR C18 ACERT

Rated @ 1000 BHP @ 2300 RPM's

RPM	SPEED (KNOTS)	FUEL CONS. (ENGINES ONLY)	RANGE NAUT. MI. (ENGINES)	HOURS @ SPEED
2300	28-30	105	262	9.0
2100	25-27	83	298	11.4
2000	23-25	75	304	12.7
1800	19-21	61	311	15.6

Hatteras 60 Motor Yacht

Standard Fuel

1000 Gallons / 3,785 Liters

Displacement

87,700 lbs. / 39,780 Kilos Full Load

Fuel consumption is based on two (2) engines at any given RPM.

Speed and ranges are estimates based on engineering calculations. Range is based on 95% of standard fuel capacity. Actual performance will vary and be affected by water and weather conditions, load and conditions of boat, engines, and propellers. Speed will increase as fuel is consumed. All data is illustrative and is not warranted.

Performance Data

2

Engines: (2) CATERPILLAR C18 ACERT

Rated @ 1135 BHP @ 2300 RPM's

RPM	SPEED (KNOTS)	FUEL CONS. (ENGINES ONLY)	RANGE NAUT. MI. (ENGINES)	HOURS @ SPEED
2300	30-32	114	258	8.3
2100	26-28	87	300	10.9
2000	24-26	80	297	11.9
1800	20-22	66	302	14.4

Standards

- Solid fiberglass hull bottom
- PVC foam core in hull sides
- Painted Exterior
- 196 square foot flybridge including boat deck
- Centerline helm
- Icom VHF
- Furuno RD30 depth and temp
- aft deck w/molded bench seat
- 130 square foot full beam master stateroom
- 15.5HP electric bow thruster
- 21.5 kW Onan generator
- 2 Year Limited, 10 Year Hull Warranty



60MY Tank Location & Volume

Fuel Tank
1000 Gallons

Water Tank
250 Gallons

Holding Tank
100 Gallons

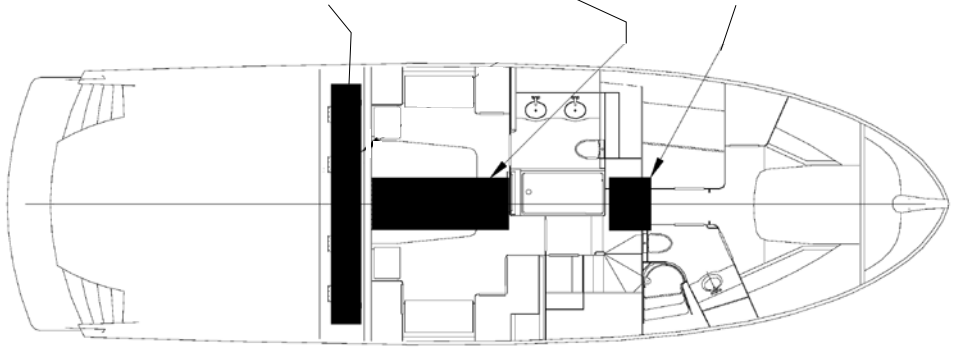



72 MOTOR YACHT

Specifications

Length Overall	73'4"
Beam	20'2"
Draft	5'4"
Freeboard Forward	8'5"
Freeboard Aft	8'3"
Headroom Most Areas	6'8"
Freshwater Capacity	300 gallons
Fuel Capacity	2,220 gallons
Holding Capacity	330 gallons
Weight Displacement	160,000 pounds
Height above waterline	17'9"
Waterline Length	65'0"

Engines

CAT C32 A (standard)	1600 BHP
CAT C32 A	1700 BHP
CAT C32 A	1800 BHP
CAT C32 A	1800 BHP
MTU 10V2000 CR	1500 BHP



72MY Arrangements

Flybridge Arrangement



Standard Upper Deck Arrangement



Optional Upper Deck Arrangement



72MY Arrangements

Standard Stateroom Arrangement



Optional Stateroom, His/Hers, Crew Arrangement

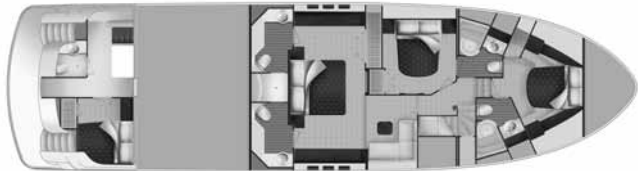

Optional 4 Stateroom, 3 Head, Aft VIP

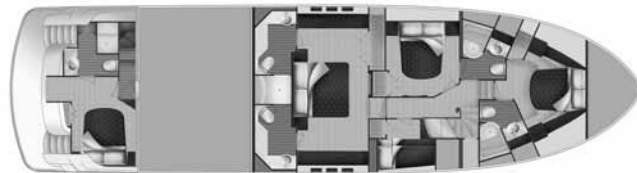

Hatteras 72 Motor Yacht

Optional Integrated Hardtop



Open Flybridge



Enclosed Flybridge

Hatteras 72 Motor Yacht

Standard Fuel
2220 Gallons / 8,404 Liters

Displacement
160,000 lbs. / 72,575 Kilos Full Load

*Fuel consumption is based on two
(2) engines at any given RPM.*

Speed and ranges are estimates based on engineering calculations. Range is based on 95% of standard fuel capacity. Actual performance will vary and be affected by water and weather conditions, load and conditions of boat, engines, and propellers. Speed will increase as fuel is consumed. All data is illustrative and is not warranted.

**The above performance numbers are reflective of open flybridge models only.*

Performance Data

1

Engines: (2) C32 CATERPILLAR DIESEL Rated @ 1600 BHP @ 2300 RPM's

RPM	SPEED (KNOTS)	FUEL CONS. (ENGINES ONLY)	RANGE NAUT. MI. (ENGINES)	HOURS @ SPEED
2300	23-25	162	311	13.0
2100	21-23	116	398	18.1
2000	20-22	106	416	19.8
1800	17-19	88	430	23.9

Engines: (2) C32 CATERPILLAR DIESELS Rated @ 1700 BHP @ 2300 RPM's

RPM	SPEED (KNOTS)	FUEL CONS. (ENGINES ONLY)	RANGE NAUT. MI. (ENGINES)	HOURS @ SPEED
2300	24-26	179	293	11.7
2100	22-24	128	377	16.4
2000	21-23	118	392	17.8
1800	18-20	94	424	22.3

Hatteras 72 Motor Yacht

Standard Fuel
2220 Gallons / 8,404 Liters

Displacement
160,000 lbs. / 72,575 Kilos Full Load

*Fuel consumption is based on two
(2) engines at any given RPM.*

Speed and ranges are estimates based on engineering calculations. Range is based on 95% of standard fuel capacity. Actual performance will vary and be affected by water and weather conditions, load and conditions of boat, engines, and propellers. Speed will increase as fuel is consumed. All data is illustrative and is not warranted.

**The above performance numbers are reflective of open flybridge models only.*

Performance Data

2

Engines: (2) C32 ACERT CATERPILLAR DIESELS Rated @ 1800 BHP @ 2300 HPM's

RPM	SPEED (KNOTS)	FUEL CONS. (ENGINES ONLY)	RANGE NAUT. MI. (ENGINES)	HOURS @ SPEED
2300	25-27	188	290	11.2
2100	23-25	140	360	15.0
2000	22-24	120	403	17.5
1800	18-20	98	407	21.4

Engines: (2) C32 ACERT CATERPILLAR DIESELS Rated @ 1900 BHP @ 2300 RPM's

RPM	SPEED (KNOTS)	FUEL CONS. (ENGINES ONLY)	RANGE NAUT. MI. (ENGINES)	HOURS @ SPEED
2300	26-28	198	286	10.6
2100	24-26	160	328	13.1
2000	23-25	141	357	14.9
1800	19-21	110	382	19.1

Hatteras 72 Motor Yacht

Standard Fuel
2220 Gallons / 8,404 Liters

Displacement
160,000 lbs. / 72,575 Kilos Full Load

*Fuel consumption is based on two
(2) engines at any given RPM.*

Speed and ranges are estimates based on engineering calculations. Range is based on 95% of standard fuel capacity. Actual performance will vary and be affected by water and weather conditions, load and conditions of boat, engines, and propellers. Speed will increase as fuel is consumed. All data is illustrative and is not warranted.

**The above performance numbers are reflective of open flybridge models only.*

Performance Data

3

Engines: (2) DD 10V2000CR MTU DIESELS Rated @ 1500 BHP @ 2450 RPM's

RPM	SPEED (KNOTS)	FUEL CONS. (ENGINES ONLY)	RANGE NAUT. MI. (ENGINES)	HOURS @ SPEED
2450	23-25	158	319	13.3
2200	20-22	116	380	18.1
2000	18-20	90	443	23.3
1800	16-18	82	435	25.6

Standards

- Solid fiberglass hull bottom
 - PVC foam core in hull sides
 - Painted Exterior
 - Forced air induction system
 - 432 square foot flybridge including boat deck
 - Icom VHF
 - Furuno RD30 depth and temp
 - Northstar 6101i GPS/Plotter
 - Simrad autopilot
 - 108 square foot aft deck w/molded bench seat and solid surface table
 - 42" TV in salon
 - Walk-in pantry in galley
- (Can be converted into optional day head)*
- 42" upright Sub-Zero refrigerator/
freezer in galley
 - Full Beam master stateroom
 - Hydraulic bow thruster
 - Two 27.5 kW Onan generators
 - Two 100 amp retractable shore cords
on bow deck
 - 1000 lb hydraulic davit on boat deck
 - **2 Year Limited, 10 Year Hull Warranty**



72MY Tank Location & Volume

Fuel Tank
740 Gallons

Water Tank
150 Gallons

Fuel Tank
1020 Gallons

Gray Water
185 Gallons

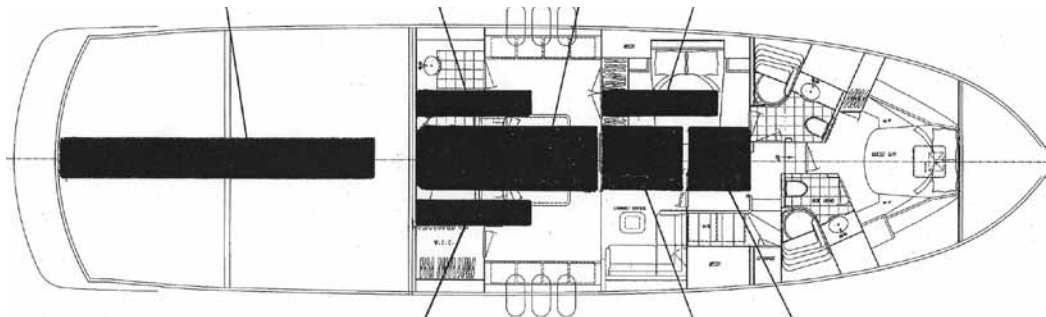

Water Tank
150 Gallons

Fuel Tank
460 Gallons

Holding Tank
330 Gallons

80

MOTOR YACHT

Specifications

Length Overall	79'10"
Beam	21'3"
Draft	5'8"
Freeboard Forward	8'1"
Freeboard Aft	6'10"
Headroom Most Areas	6'6"
Freshwater Capacity	326 gallons
Fuel Capacity	2,858 gallons
Holding Capacity	388 gallons
Weight Displacement	190,000 pounds
Height above waterline (Top of arch)	18'10"
Waterline Length	68'10"

Engines

CAT C32 A (Standard)	1600 BHP
CAT C32 A	1700 BHP
CAT C32 A	1800 BHP
CAT C32 A	1900 BHP
MTU 16V2000	2000 BHP
MTU 16V2000 CR	2400 BHP



80MY Arrangements

Standard Upper Deck arrangement

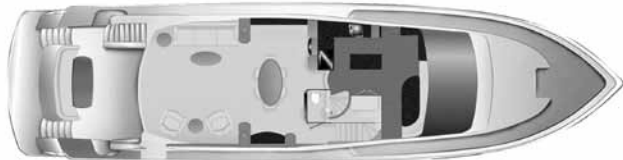

Optional Lower Helm & Sunken Bar

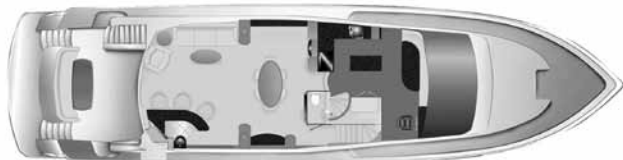

Standard Lower Arrangement

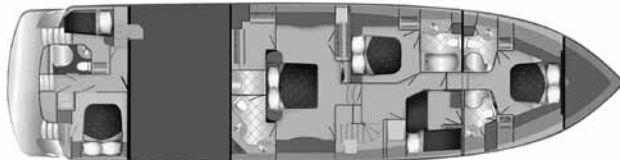

Optional Lower Arrangement w/ His & Hers Head

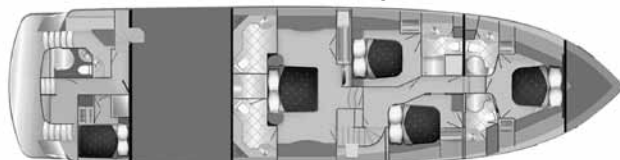

80MY Arrangements

Standard Flybridge Arrangement

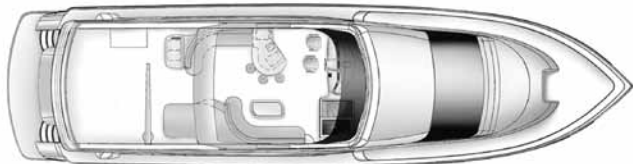

Flybridge Arrangement w/ Optional Hot Tub

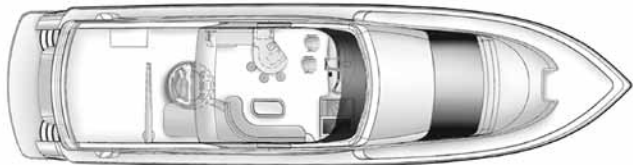

Enclosed Bridge Layout

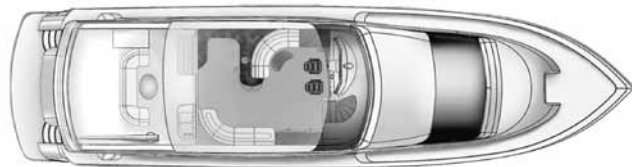

Standards

- Solid fiberglass hull bottom
- PVC foam core in hull sides
- Painted Exterior
- Forced air induction system
- 484 square foot flybridge including boat deck
- Ethernet Monitoring System with LCD touchpad
- Icom VHF
- Furuno RD30 depth and temp
- Northstar 6101i GPS/Plotter
- Simrad autopilot
- 42" TV in salon
- Day head in salon
- 42" upright Sub-Zero refrigerator/ freezer in galley
- Full beam master stateroom
- Integrated hydraulic bow thruster and stabilizer system
- Two 27.5 kW Onan generators
- Two 100 amp retractable shore cords on bow deck
- 1400 GPD watermaker
- 1500 lb Hydraulic Davit
- Crew's quarters
- **2 Year Limited, 10 Year Hull Warranty**

80MY Tank Location & Volume

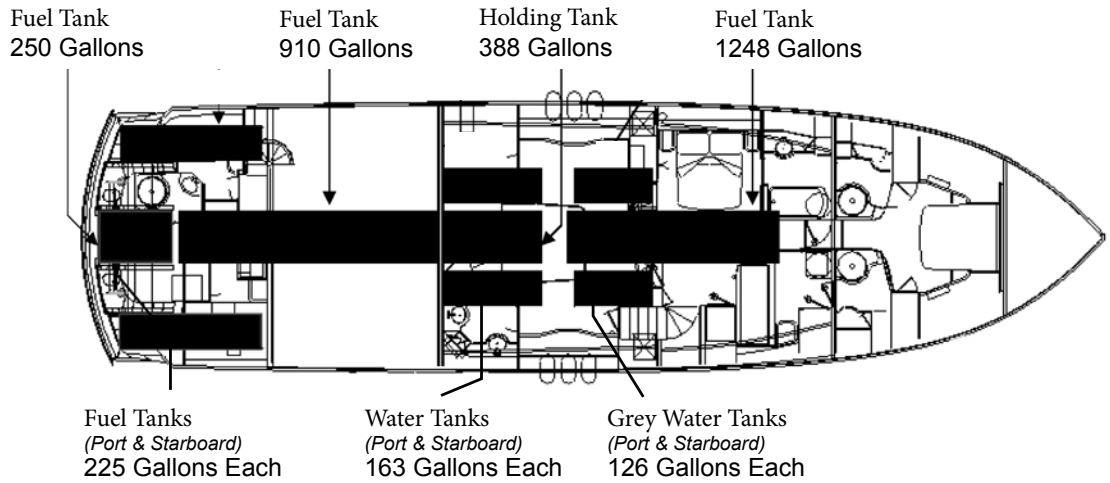

Hatteras 80 Motor Yacht

Standard Fuel
2858 Gallons / 10,819 Liters

Displacement
190,000 lbs. / 86,183 Kilos Full Load

*Fuel consumption is based on two
(2) engines at any given RPM.*

Speed and ranges are estimates based on engineering calculations. Range is based on 95% of standard fuel capacity. Actual performance will vary and be affected by water and weather conditions, load and conditions of boat, engines, and propellers. Speed will increase as fuel is consumed. All data is illustrative and is not warranted.

Hatteras 80 Motor Yacht Performance Data

1

Engines: (2) C32 ACERT CATERPILLAR DIESELS Rated @ 1600 BHP @ 2300 RPM's

RPM	SPEED (KNOTS)	FUEL CONS. (ENGINES ONLY)	RANGE NAUT. MI. (ENGINES)	HOURS @ SPEED
2300	23-25	166	393	16.4
2100	20-22	114	500	23.8
2000	17-19	98	499	27.7
1800	15-17	82	530	33.1

Engines: (2) C32 ACERT CATERPILLAR DIESELS Rated @ 1700 BHP @ 2300 RPM's

RPM	SPEED (KNOTS)	FUEL CONS. (ENGINES ONLY)	RANGE NAUT. MI. (ENGINES)	HOURS @ SPEED
2300	23-25	172	379	15.8
2100	20-22	120	475	22.6
2000	17-19	102	479	26.6
1800	15-17	84	517	32.3

Hatteras 80 Motor Yacht

Standard Fuel
2858 Gallons / 10,819 Liters

Displacement
190,000 lbs. / 86,183 Kilos Full Load

*Fuel consumption is based on two
(2) engines at any given RPM.*

Speed and ranges are estimates based on engineering calculations. Range is based on 95% of standard fuel capacity. Actual performance will vary and be affected by water and weather conditions, load and conditions of boat, engines, and propellers. Speed will increase as fuel is consumed. All data is illustrative and is not warranted.

Performance Data

2

Engines: (2) C32 ACERT CATERPILLAR DIESELS Rated @ 1800 BHP @ 2300 RPM's

RPM	SPEED (KNOTS)	FUEL CONS. (ENGINES ONLY)	RANGE NAUT. MI. (ENGINES)	HOURS @ SPEED
2300	24-26	188	361	14.4
2100	21-23	138	433	19.7
2000	18-20	116	445	23.4
1800	15-17	94	462	28.8

Engines: (2) C32 ACERT CATERPILLAR DIESELS Rated @ 1900 BHP @ 2300 RPM's

RPM	SPEED (KNOTS)	FUEL CONS. (ENGINES ONLY)	RANGE NAUT. MI. (ENGINES)	HOURS @ SPEED
2300	25-27	198	357	14.4
2100	22-24	160	390	19.7
2000	19-21	122	445	23.4
1800	16-18	99	466	28.8

Hatteras 80 Motor Yacht

Standard Fuel
2858 Gallons / 10,819 Liters

Displacement
190,000 lbs. / 86,183 Kilos Full Load

*Fuel consumption is based on two
(2) engines at any given RPM.*

Speed and ranges are estimates based on engineering calculations. Range is based on 95% of standard fuel capacity. Actual performance will vary and be affected by water and weather conditions, load and conditions of boat, engines, and propellers. Speed will increase as fuel is consumed. All data is illustrative and is not warranted.

Performance Data

3

Engines: (2) 16V-2000 MTU DIESELS Rated @ 2000 BHP @ 2350 RPM's

RPM	SPEED (KNOTS)	FUEL CONS. (ENGINES ONLY)	RANGE NAUT. MI. (ENGINES)	HOURS @ SPEED
2350	25-27	202	349	13.4
2100	22-24	136	459	20.0
2000	19-21	116	468	23.4
1800	16-18	98	471	27.7

Engines: (2) 16V2000CR MTU DIESELS Rated @ 2400 BHP @ 2450 RPM's

RPM	SPEED (KNOTS)	FUEL CONS. (ENGINES ONLY)	RANGE NAUT. MI. (ENGINES)	HOURS @ SPEED
2450	28-30	244	323	11.1
2200	25-27	213	331	12.7
2100	23-25	193	338	14.1
2000	22-24	172	363	15.8
1800	20-22	130	439	20.9



100 MOTOR YACHT

Specifications

Length Overall	100'5"
Beam	22'6"
Draft	6'3"
Freeboard Forward	10'9"
Freeboard Aft	9'3"
Headroom Most Areas	6'6"
Freshwater Capacity	840 gallons
Fuel Capacity	5,000 gallons
Holding Capacity	370 gallons
Weight Displacement	275,000 pounds
Height above waterline	21'5"
Waterline Length	90'8"

Engines

CAT C32 A	1800 BHP
CAT C32 A	1900 BHP
MTU 16V2000	2000 BHP
MTU 16V2000 CR	2400 BHP



100MY Arrangements

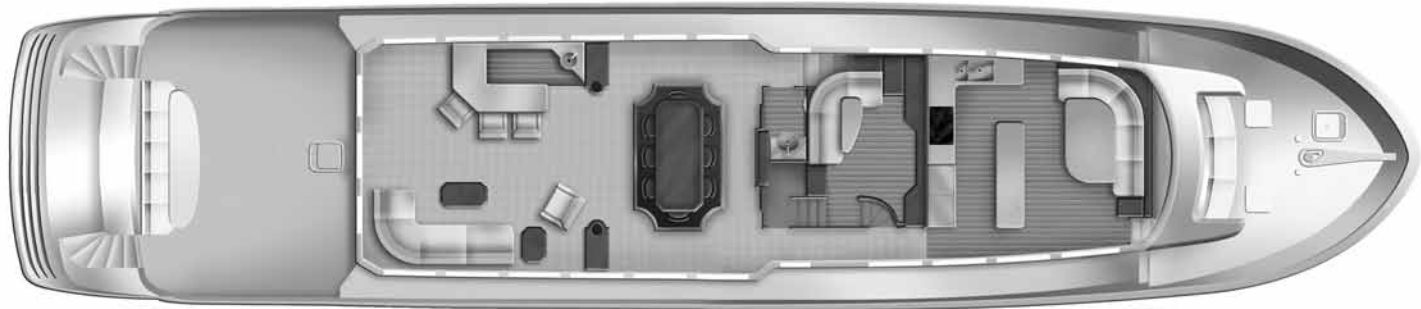

Upper Deck Arrangement

100MY Arrangements

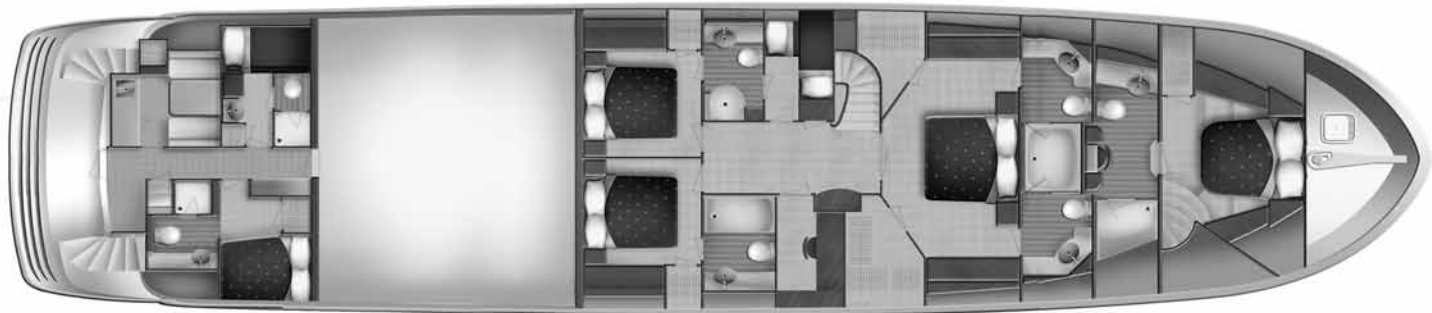

Lower Deck Arrangement w/ Optional Office

Hatteras 100MY

Standard Fuel

5000 Gallons / 18,921 Liters

Displacement

275,000 lbs. / 124,737 Kilos Full Load

Fuel consumption is based on two (2) engines at any given RPM.

Speed and ranges are estimates based on engineering calculations. Range is based on 95% of standard fuel capacity. Actual performance will vary and be affected by water and weather conditions, load and conditions of boat, engines, and propellers. Speed will increase as fuel is consumed. All data is illustrative and is not warranted.

Performance Data

1

Engines: (2) C32 ACERT CATERPILLAR DIESELS Rated @ 1800 BHP @ 2300 RPM's

RPM	SPEED (KNOTS)	FUEL CONS. (ENGINES ONLY)	RANGE NAUT. MI. (ENGINES)	HOURS @ SPEED
2300	23-25	188	609	25.4
2100	19-21	146	654	32.7
2000	17-19	125	687	38.2
1800	11-13	102	562	46.8

Engines: (2) C32 ACERT CATERPILLAR DIESELS Rated @ 1900 BHP @ 2300 RPM's

RPM	SPEED (KNOTS)	FUEL CONS. (ENGINES ONLY)	RANGE NAUT. MI. (ENGINES)	HOURS @ SPEED
2300	24-26	198	603	24.1
2100	20-22	158	634	30.2
2000	18-20	125	725	38.2
1800	12-14	102	608	46.8

Hatteras 100MY

Standard Fuel
5000 Gallons / 18,921 Liters

Displacement
275,000 lbs. / 124,737 Kilos Full Load

*Fuel consumption is based on two
(2) engines at any given RPM.*

Speed and ranges are estimates based on engineering calculations. Range is based on 95% of standard fuel capacity. Actual performance will vary and be affected by water and weather conditions, load and conditions of boat, engines, and propellers. Speed will increase as fuel is consumed. All data is illustrative and is not warranted.

Performance Data

2

Engines: (2) 16V-2000 MTU DIESELS

Rated @ 2000 BHP @ 2350 RPM's

RPM	SPEED (KNOTS)	FUEL CONS. (ENGINES ONLY)	RANGE NAUT. MI. (ENGINES)	HOURS @ SPEED
2350	24-26	202	591	23.6
2100	20-22	146	687	32.7
2000	19-21	127	714	37.6
1800	13-15	106	585	45.0

Engines: (2) 16V-2000CR MTU DIESELS

Rated @ 2400 BHP @ 2450 RPM's

RPM	SPEED (KNOTS)	FUEL CONS. (ENGINES ONLY)	RANGE NAUT. MI. (ENGINES)	HOURS @ SPEED
2450	26-28	244	528	19.6
2200	22-24	213	515	22.4
2100	21-23	193	544	24.7
2000	19-21	172	555	27.8
1800	13-15	130	514	36.7